

Overview

With dual-head support (NG815AA)

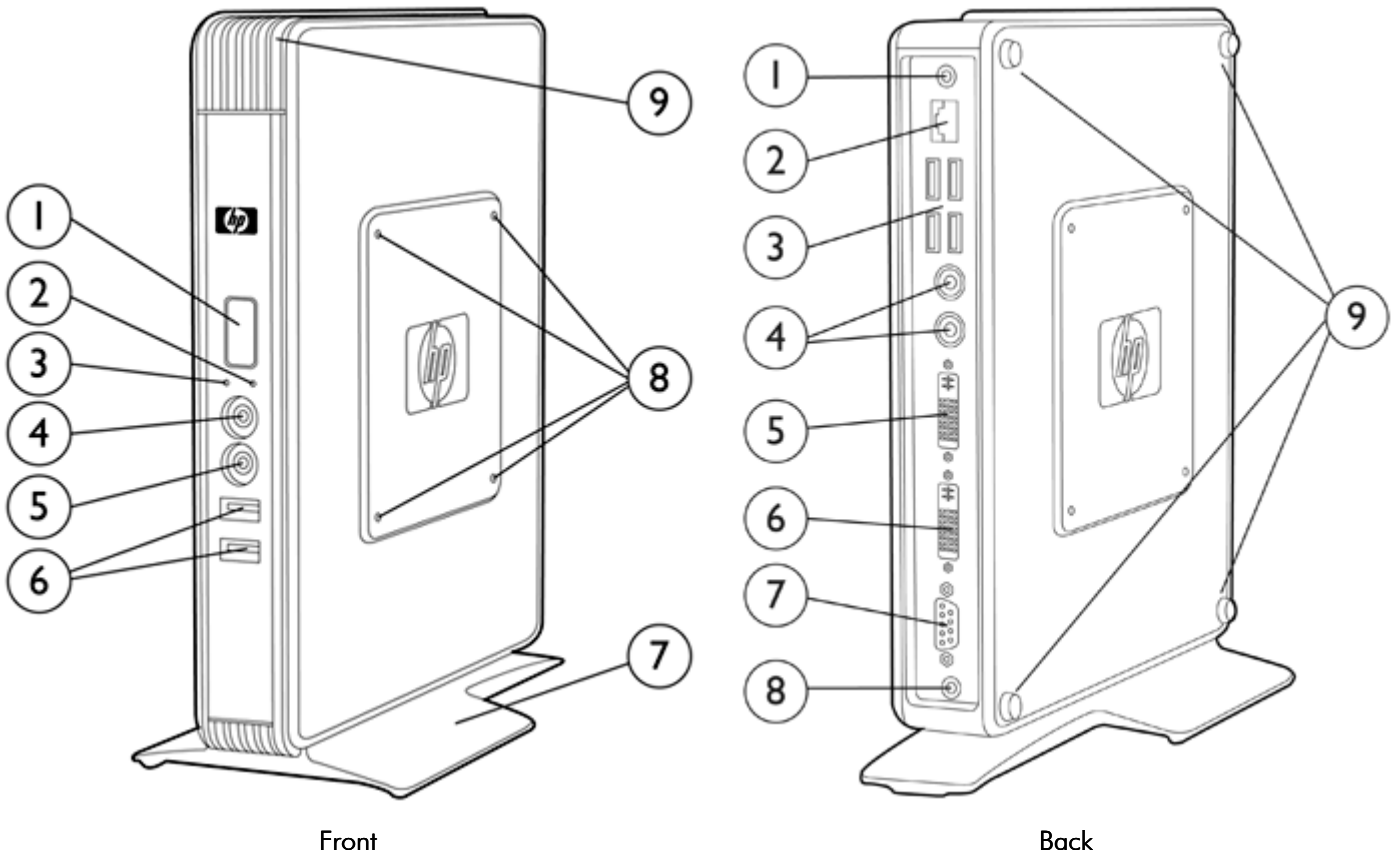

Front

Back

1. Power button
2. Power on indicator
3. Flash activity indicator
4. Audio connector (headphone/speaker out)
5. Audio connector (mic in)
6. USB connectors (two)
7. Removable stand for vertical orientation
8. Mounting points for HP Quick Release
9. Secure USB compartment

1. Audio out
2. Ethernet RJ-45 connector
3. USB connectors (four)
4. PS/2 connectors (two)
5. DVI-I monitor connector
6. DVI-D monitor connector
7. Serial connector
8. +12V DC power input
9. Feet for horizontal orientation (four)

Overview

With quad-head support (NG816AA)

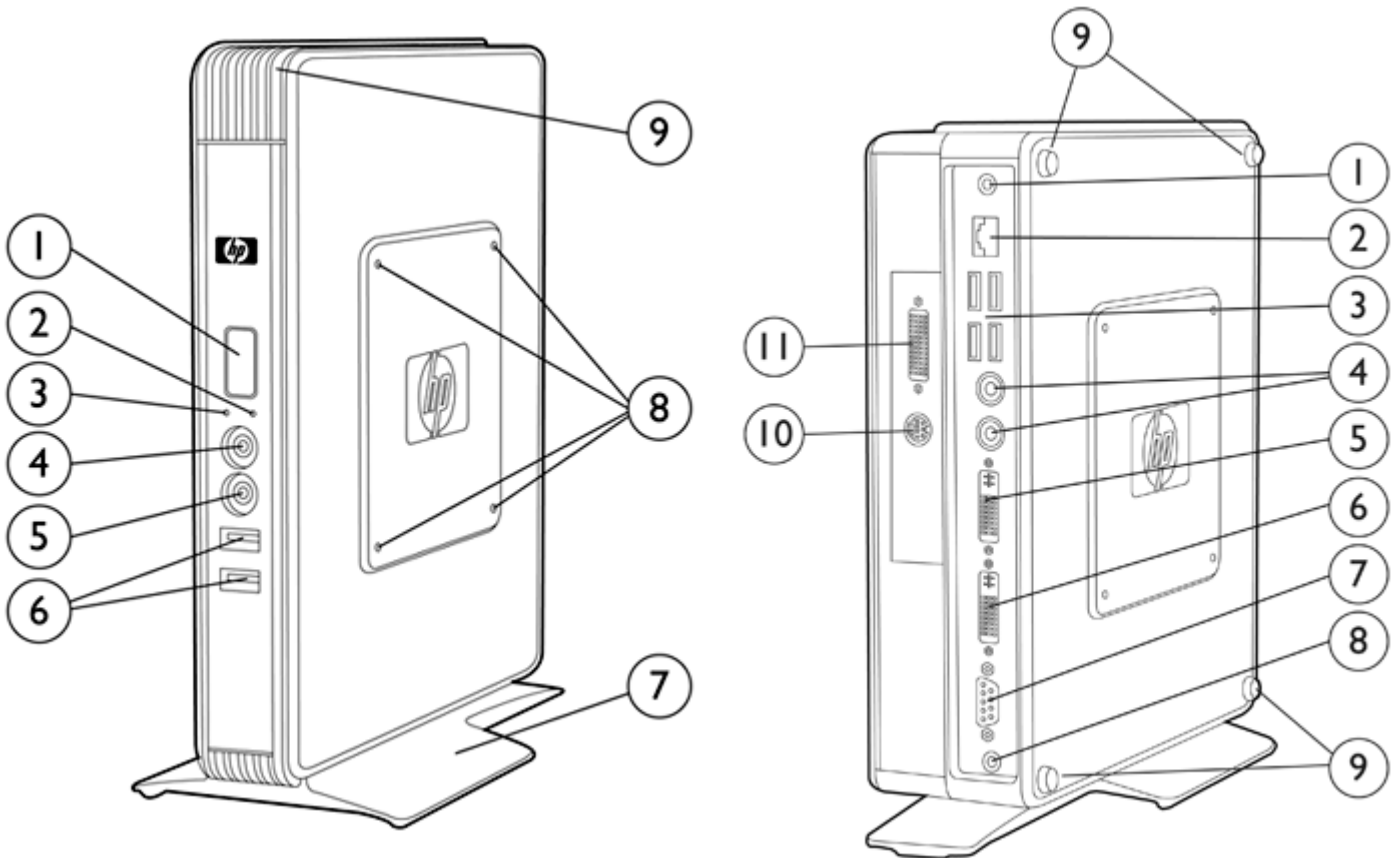

1. Power button
2. Power on indicator
3. Flash activity indicator
4. Audio connector (headphone/speaker out)
5. Audio connector (mic in)
6. USB connectors (two)
7. Removable stand for vertical orientation
8. Mounting points for HP Quick Release
9. Secure USB compartment

1. Audio out
2. Ethernet RJ-45 connector
3. USB connectors (four)
4. PS/2 connectors (two)
5. DVI-I monitor connector
6. DVI-D monitor connector
7. Serial connector
8. +19V DC power input
9. Feet for horizontal orientation (four)
10. S-Video out (not supported)
11. DMS-59 connector for two DVI-I outputs (splitter cable included)

Overview

At A Glance

- As part of our specialty thin client series, the HP gt7725 is HP's most powerful thin client
- Outstanding performance with AMD Turion dual-core 2.3GHz processor¹
 - Harness the horsepower of a blade workstation client in a compact footprint
 - Configured with dual channel memory, data throughput is further optimized, bringing new levels of system performance to thin clients
- Excellent rich multimedia experience, ideal for HP Remote Graphics Software (RGS), Web 2.0 and rich Internet applications, and enhanced browsing
- Optimized for streaming media VDI and blade implementations, supporting impressive delivery of streaming media and USB redirection over remote connections with preinstalled HP Remote Graphics Software (RGS)
- Multi-display support for maximum productivity
 - Built in dual monitor support (DVI-I and DVI-D native)
 - Efficiently multi-task with up to two 30-inch diagonal or four 24-inch diagonal displays, standard or wide-screen, to maximize desktop space (displays sold separately; number supported varies by model)
 - Multi-display rotation allows for a mixture of portrait or landscape orientations across displays
 - Client Aggregation software feature allows you to connect up to four gt7725 devices, supporting up to 16 monitors, controlled by a single keyboard and mouse.
- Impressive resolution, supporting 24-inch and 30-inch diagonal displays
 - Capable of driving ultra high resolutions for a unified desktop
 - With two 30-inch diagonal monitors, get up to 5120x1600 (at 2560x1600 per display), or with four 24-inch diagonal monitors, up to 7680x1200 or 3840x2400 (at 1920x1200 per display) resolutions (displays sold separately; number supported varies by model)
- HP ThinPro GT OS with support for local applications, Debian Package Manager, and Synaptic Installer
- Generous memory -- 1 GB flash memory provides ample storage for drivers and applications; 2 GB dual channel system memory (256 MB reserved for graphics memory)
- Includes appliance desktop interface, Debian Iceweasel (Firefox) browser, Citrix ICA, RDesktop (RDP client), HP Remote Graphics Software client, HP Session Allocation Manager (SAM) client, HP Thinstate, and full license for Altiris Deployment Solution
- Legacy support includes serial, and PS/2 connections, along with eight USB 2.0 ports
- Supports AMD Cool 'N' Quiet technology available to help further enhance energy efficiency
- Protected by Hewlett-Packard Services, including a limited three-year mail-in warranty (certain restrictions and exclusions apply)

¹ This system requires a separately purchased 64-bit operating system and 64-bit software products to take advantage of the 64-bit processing capabilities of AMD technology. Dual/quad/triple-core processing available with AMD technology is designed to improve performance of this system. Given the wide range of software applications available, performance of a system including a 64-bit operating system and a dual-core processor will vary.

Standard Features – Models

NG815AA#ABA (standard, dual head native)	Processor	AMD Turion Dual Core CPU (2.3GHz) ¹
	Operating System	HP ThinPro GT
	Flash Memory	1 GB
	Memory	2GB DDR-2 SODIMM (dual channel, 2x 1GB modules) NOTE: 256 MB reserved for graphics memory
	Graphics	Integrated: AMD RS780G integrated graphics (ATI Radeon HD 3200 Graphics)
	Browser	Debian Iceweasel (Firefox)
	Client Management Software	HP Device Manager, Altiris Deployment Solution (full license DS 6.9 SP1), HP ThinState included with each thin client
	Terminal Personalities	Standard
	Keyboard	USB or PS/2; varies by region.
	Mouse	USB or PS/2; varies by region.

NG816AA#ABA (quad-head capable)	Processor	AMD Turion Dual Core CPU (2.3GHz) ¹
	Operating System	HP ThinPro GT
	Flash Memory	1 GB
	Memory	2GB DDR-2 SODIMM (dual channel, 2x 1GB modules) NOTE: 256 MB reserved for graphics memory
	Graphics	Integrated: AMD RS780G integrated graphics (ATI Radeon HD 3200 Graphics) Also includes: ATI Fire MV 2250 (PCI Express x16), DMS-59 x 2 dual DVI-I (via splitter cable, included)
	Browser	Debian Iceweasel (Firefox)
	Client Management Software	HP Device Manager, Altiris Deployment Solution (full license DS 6.9 SP1), HP ThinState included with each thin client
	Terminal Personalities	Standard
	Keyboard	USB or PS/2; varies by region.
	Mouse	USB or PS/2; varies by region.

¹ This system requires a 64-bit operating system and 64-bit software products to take advantage of the 64-bit processing capabilities of AMD technology. Dual/quad/triple-core processing available with AMD technology is designed to improve performance of this system. Given the wide range of software applications available, performance of a system including a 64-bit operating system and a dual-core processor will vary.

Options

		Part Number
Accessories	HP Quick Release Kit	EM870AA
	HP/Kensington Cable Lock	PC766A
	120 Watt External Power Supply	NH527AA
Expansion/graphics	PCIe Expansion Module	NH524AA
	ATI Fire MV 2250 (PCI Express x16)	NH525AA
Input Devices	HP PS/2 Standard Keyboard	DT527A#ABA
	HP USB Standard Keyboard	DT528A#ABA
	HP USB Smartcard Keyboard	ED707AA#ABA
	HP PS/2 2-Button Optical Mouse	EY703AA
	HP USB 2-Button Optical Scroll Mouse	DC172B
Touch screen monitors³	ELO Touch 1529L Flat Panel – USB /serial combo ^{1,2}	E926109
	HP L5006tm LCD Touchscreen – USB/serial combo ²	RB146AA
Memory	Apacer 4 GB AH522 USB 2.0 Flash Drive (DOK)	AP-FM409G-MM002-A
Security	HP USB Smartcard Keyboard	ED707AA
	SCM USB Smart Card Reader SCR331 ¹	904054
	HP/Kensington Cable Lock	PC766A
Care Pack Services^{4,5}	9x5 Next-Business-Day Advanced Exchange – 3 Years	331653-001; U4847E
	9x5 Next-Business-Day On-Site Coverage – 3 Years	331655-001; U4849E
	Hardware Installation	331686-001; U4865E

NOTE: Although third-party products may work effectively on HP thin clients, these non-HP products are provided "AS IS." HP does not support or warrant third-party products, including the interoperability of such products with HP thin clients. However, third-party manufacturers and vendors may provide their own warranties and support directly to you. Please contact the manufacturers or vendors for hardware or software support on their products.

¹Option and support available directly from third party.

²When selecting a monitor, it is important to cross-reference the supported video resolutions of the HP thin client to the supported resolutions of the monitor. Most HP monitors have one or more supported resolutions that match HP thin client products.

³Only serial is supported.

⁴Service levels and response times for HP Care Pack Services may vary depending on your geographic location. Restrictions and limitations apply. Service starts from date of hardware purchase. For details, visit: www.hp.com/go/carepack.

⁵U4847E is available in all regions; U4849E is available in Americas and Asia-Pacific/Japan.

Technical Specifications

Processor	AMD Turion Dual Core CPU (2.3GHz) NOTE: This system requires a 64-bit operating system and 64-bit software products to take advantage of the 64-bit processing capabilities of AMD technology. Dual/quad/triple-core processing available with AMD technology is designed to improve performance of this system. Given the wide range of software applications available, performance of a system including a 64-bit operating system and a dual-core processor will vary.
Memory	Chipset ATI RS780G; SB700 Flash Memory 1 GB System Memory 2GB DDR-2 SODIMM (dual channel) NOTE: 256 MB reserved for graphics memory
Graphics (support for unified desktop available)	Dual-head-capable configuration: AMD RS780G integrated graphics (ATI Radeon HD 3200 Graphics) Dual integrated digital display controllers supporting up to two displays at 2560x1600 per display. Resolutions supported include, but are not limited to: up to 5120x1600*, 3840x1200*, 3360x1080*, 3200x900* 2560x1600, 1920x1200, 1920x1080, 1680x1050, 1600x1000, 1600x900, 1440x900, 1366x768, 1280x1024, 1024x768 *2560 x 1600/display Also included on quad-head-capable configuration: ATI Fire MV 2250 (PCI Express x16) , DMS-59 x 2 dual DVI-I (via splitter cable) Dual integrated digital display controllers supporting up to two displays at 1920x1200 per display. Resolutions supported include, but are not limited to: up to 7680x1200*, 3840x2400*, 1920x4800*, 6720x1050* 1920x1200, 1920x1080, 1680x1050, 1600x1200, 1600x1000, 1600x900, 1440x900, 1366x768, 1280x1024, 1024x768 *1920x1200/display
Input/Output/ Peripheral Support	Keyboard USB or PS/2 (varies by region) Mouse USB or PS/2 (varies by region) Printer Local and/or network printers (RDP, ICA, LPD) as per the printer support statement Video ATI RS780G
Audio	Output Internal amplified speaker, 1/8-inch mini, full 16-bit stereo, 44-kHz sample rate Input 1/8-inch mini microphone
Security	One security lock slot (cable lock sold separately) Support for Smart Card options
Networking	10/100/1000 Gigabit Ethernet, twisted pair (RJ-45) TCP/IP with Dynamic DNS and DHCP support Point-to-Point Protocol (PPP), Direct Connection through RS-232, Wake on LAN (WOL), PXE bcm5787m Broadcom Netlink™ Gigabit Ethernet
I/O ports and connectors	Eight USB 2.0 ports (two in front, four in rear, two in secure USB compartment), Dual link DVI-Ix1, DVI-Dx1, 2 PS/2, 1 serial, 1 RJ-45
Resident Operating System	HP ThinPro GT



Technical Specifications

Server OS Compatibility/Support	Citrix Presentation Server (up to 4.5) Citrix Metaframe Presentation Server 3.0, Citrix Metaframe XP Presentation Server Citrix Metaframe 1.x Windows 2000/2003 Server families, Windows 2000/2003 Server Terminal Services Windows 2000 Advanced Server, Windows 2000 Advance Server Terminal Services Microsoft® Windows® NT 4.0 Server, Windows NT 4.0 Terminal Server Edition VMware Virtual Desktop Infrastructure using RDP
Session Allocation Managers/Session Brokers	HP Session Allocation Manager (SAM) Citrix XenDesktop DDC broker VMware VDM broker Leostream Desktop Connection Broker Provision Networks (Quest) Virtual Access Broker
Software Included	HP Remote Graphics Software Receiver 5.1.6 (RGS 5.2 available as add-on) Citrix ICA 10.x, RDesktop (RDP client) 1.6, TeemTalk terminal emulation software Firefox browser Debian Package Manager, Synaptic Installer HP ThinState for rapid deployment Device Manager Management agent Altiris Deployment Solution (full client license). Altiris Deployment Solution (management console) available as free download from Altiris at: www.altiris.com/hptc HP Client Automation available Other software available as add-ons (see www.hp.com/support for latest list of available add-ons)
OS Languages	English
Localization kit	HP Thin Client country kit (please refer to TC localization matrix)
Dimensions H x W x D (approximate)	Without stand 10.0 x 1.8 x 8.47 in (254.5 x 45.7 x 215.14 mm) With stand 10.5 x 1.8 x 8.47 in (266.7 x 45.7 x 215.14 mm) With Expansion Module (quad) 10.0 x 3.0 x 8.47 in (254.5 x 76.2 x 215.14 mm)
Weight (approximate)	With stand 3.5 lb (1.6 kg) With Expansion Module (quad) 4.8 lb (2.2 kg)
Power*	Operating voltage range 100-240 VAC Rated line frequency 50-60 Hz Power output (max) 120W Rated output current (max) 6.15A Output voltage +19V DC Power consumption Idle power: 41W, dual; 61W, quad* NOTE: Additional software may be needed to enable this feature.
	*NOTE: The actual power consumption at your location could vary and is dependent on many factors including but not limited to software load on the thin client, number of attached monitors and peripherals, and environmental factors.
Environmental	Temperature range (operating) 50° to 95° F (10 to 35° C) With Expansion Module or mounted with HP Quick Release 50° to 95° F (10° to 35° C)

Technical Specifications

	Temperature range (off)	-22° to 140° F (-30 to 60° C)
	Cooling	Active
	Humidity	20% to 80% condensing 10% to 90% non-condensing
	Acoustic Level	Variable, 26 dBA idle @ ambient room temperature
Regulatory Compliance	Product Safety	International: IEC60950-1, 12:2005, with CB Certificate and all National Deviations US and Canada: UL 60950-1 / CAN/CSA 22.2 No. 60950-1-03, 07:2006, Bi-National Standard for ITE Safety in the US and Canada and is published jointly by UL and CSA. Europe: EN 60950-1, 06:2003, Information Technology Equipment
	Ergonomics	The product has been tested and found to comply with all applicable GS ergonomic requirements.
	EMC	FCC Class B; CE Mark; EN55022 B; EN55024; BMSI, KCC, CCC, C-Tick, and VCCI
Warranty		Three-year limited hardware warranty. NOTE: Certain restrictions apply. Consult the HP Customer Support Centre for details.

Emulations	Emulation	Terminal ID
	ADDS A2	
	AIXTerm	
	ANSI BBS	
	AT 386	
	DG 410	
	HP 70092	70092
	HZ1500	
	IBM3151	Mod11, Mod31
	IBM3270	3278-2 (24x80), 3278-3 (32x80), 3278-4 (43x80), 3278-5 (27x132), 3278-2-E (24x80), 3278-E (32x80), 3278-4-E (43x80), 3278-5-E (27x132), 3279-2 (24x80), 3279-3 (32x80), 3279-4 (43x80), 3279-5 (27x132), 3287-1
	IBM5250	5291-1, 5292-2, 5251-11, 3179-2, 3196-A1, 3180-2, 3477-FC (27x132), 3477-FG (24x80), 3486-BA, 3487-HA, 3487-HC, 3812-1
	SCO Console	
	TA6530	
	TVI910	
	TVI920	
	TVI925	
	TVI950	
	TVI955	
	VT52, VT100	VT100, VT101, VT102, VT125, VT131, VT132, M2200, VT220, VT240, VT320, VT340, VT420
	VT HP220	VT-HP220
	WY50	
	WY50+	
	WY60	

Technical Specifications

Environment-friendly Products and Approach RoHS Compliance

Hewlett-Packard is committed to compliance with all applicable environmental laws and regulations, including the European Union Restriction of Hazardous Substances (RoHS) Directive. HP's goal is to comply with the requirements of the RoHS Directive on a worldwide basis. From July 1, 2006, RoHS substances are being virtually eliminated by reducing substances to levels below legal limits for all HP electronic products subject to the RoHS Directive, except where it is widely recognized that there is no technically feasible alternative (as indicated by an exemption under the EU RoHS Directive).

Material Usage

This product does not contain any of the following substances in excess of regulatory limits (refer to the HP General Specification for the Environment at: http://www.hp.com/hpinfo/globalcitizenship/environment/supplychain/gen_specifications.html):

- Asbestos
- Certain Azo Colorants
- Certain Brominated Flame Retardants
- Cadmium
- Chlorinated Hydrocarbons
- Chlorinated Paraffins
- Formaldehyde
- Halogenated Diphenyl Methanes
- Lead carbonates and sulfates
- Lead and Lead compounds
- Mercuric Oxide Batteries
- Nickel
- Ozone Depleting Substances
- Polybrominated Biphenyls (PBBs)
- Polybrominated Biphenyl Ethers (PBBEs)
- Polybrominated Biphenyl Oxides (PBBOs)
- Polychlorinated Biphenyl (PCB)
- Polychlorinated Terphenyls (PCT)
- Polyvinyl Chloride (PVC)
- Tributyl Tin (TBT), Triphenyl Tin (TPT), Tributyl Tin Oxide (TBTO)

Packaging

HP follows these guidelines to decrease the environmental impact of product packaging:

- Eliminate the use of heavy metals such as lead, chromium, mercury and cadmium in packaging materials.
- Eliminate the use of ozone-depleting substances (ODS) in packaging materials.
- Design packaging materials for ease of disassembly.
- Maximize the use of post-consumer recycled content materials in packaging materials.
- Use recyclable packaging materials such as paper and corrugated materials (limited availability of recycling facilities)
- Reduce size and weight of packages to improve transportation fuel efficiency.
- Plastic packaging materials are marked according to ISO 11469 and DIN 6120 standards.

End-of-life Management Hewlett-Packard offers end-of-life HP product return and recycling programs

Technical Specifications

and Recycling

in many geographic areas.

To recycle your product, please go to: <http://www.hp.com/recycle> or contact your nearest HP sales office. Products returned to HP will be recycled, recovered or disposed of in a responsible manner.

The EU WEEE directive (2002/95/EC) requires manufacturers to provide treatment information for each product type for use by treatment facilities. This information (product disassembly instructions) is posted on the Hewlett Packard web site at: <http://www.hp.com/go/recyclers>.

These instructions may be used by recyclers and other WEEE treatment facilities as well as HP OEM customers who integrate and re-sell HP equipment.

Hewlett-Packard Corporate Environmental Information

For more information about HP's commitment to the environment:
[link to new HP white paper now in progress]

Global Citizenship Report:

<http://www.hp.com/hpinfo/globalcitizenship/gcreport/index.html>

Eco-label certifications:

<http://www.hp.com/hpinfo/globalcitizenship/environment/productdesign/ecolabels.html>

ISO 14001 certificates:

<http://www.hp.com/hpinfo/globalcitizenship/environment/operations/envmanagement.html>

© 2009 Hewlett-Packard Development Company, L.P. The information contained herein is subject to change without notice and is provided "as is" without warranty of any kind. The warranties for HP products and services are set forth in the express limited warranty statements accompanying such products and services. Nothing herein should be construed as constituting an additional warranty. HP shall not be liable for technical or editorial errors or omissions contained herein.

Microsoft, Windows, and Windows NT are trademarks or registered trademarks of Microsoft Corporation in the United States and other countries. AMD and Geode are trademarks of Advanced Micro Devices, Inc.